

CITY OF ST. ALBERT

BYLAW 34/2019

LAND USE BYLAW AMENDMENT

Being Amendment 172 to the Land Use Bylaw 9/2005

The Council of the City of St. Albert, duly assembled, hereby ENACTS AS FOLLOWS:

1. Schedule "A", being the Land Use District Map to Land Use Bylaw 9/2005, is amended by this Bylaw.
2. The lands described and shown on the map below shall be redistricted from Direct Control Mixed Use (DCMU) Land Use District to Regional Commercial (RC) Land Use District.

Municipal Address

Legal Address

2-54211 Range Road 253

Plan 942 3702, Lot C

3. The Chief Administrative Officer is authorized to consolidate Bylaw 9/2005.

EFFECTIVE DATE

4. This bylaw comes into effect when it is passed.

READ a First time this ____ day of _____ 20____.

READ a Second time this ____ day of _____ 20____.

READ a Third time this ____ day of _____ 20____.

SIGNED AND PASSED this ____ day of _____ 20____.

MAYOR

CHIEF LEGISLATIVE OFFICER

SCHEDULE 'A'

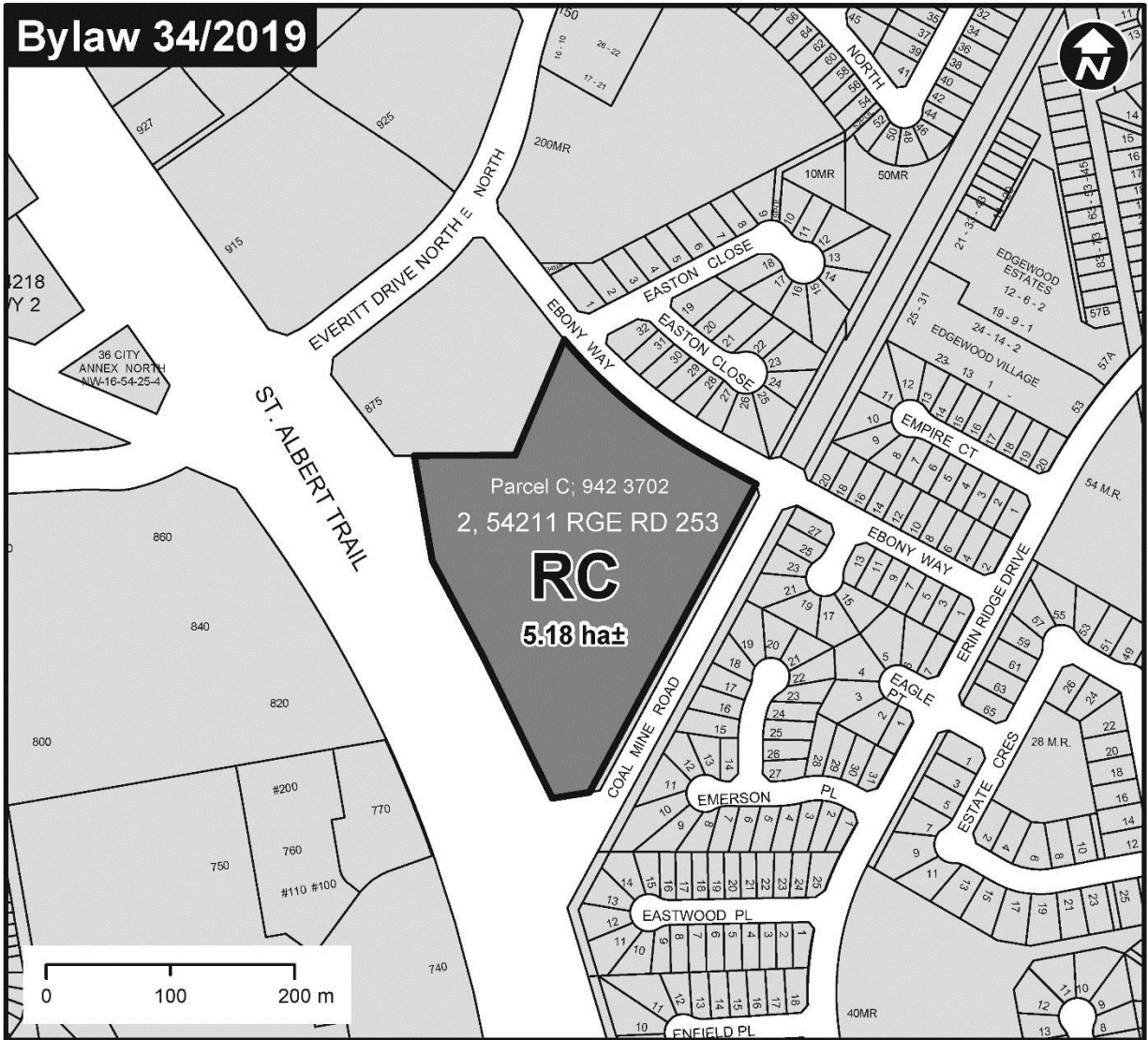

**LAND USE BYLAW AMENDMENT
#2, 54211 Range Road 253**

From: DCMU (Direct Control Mixed Use)

To:  RC (Regional Commercial)

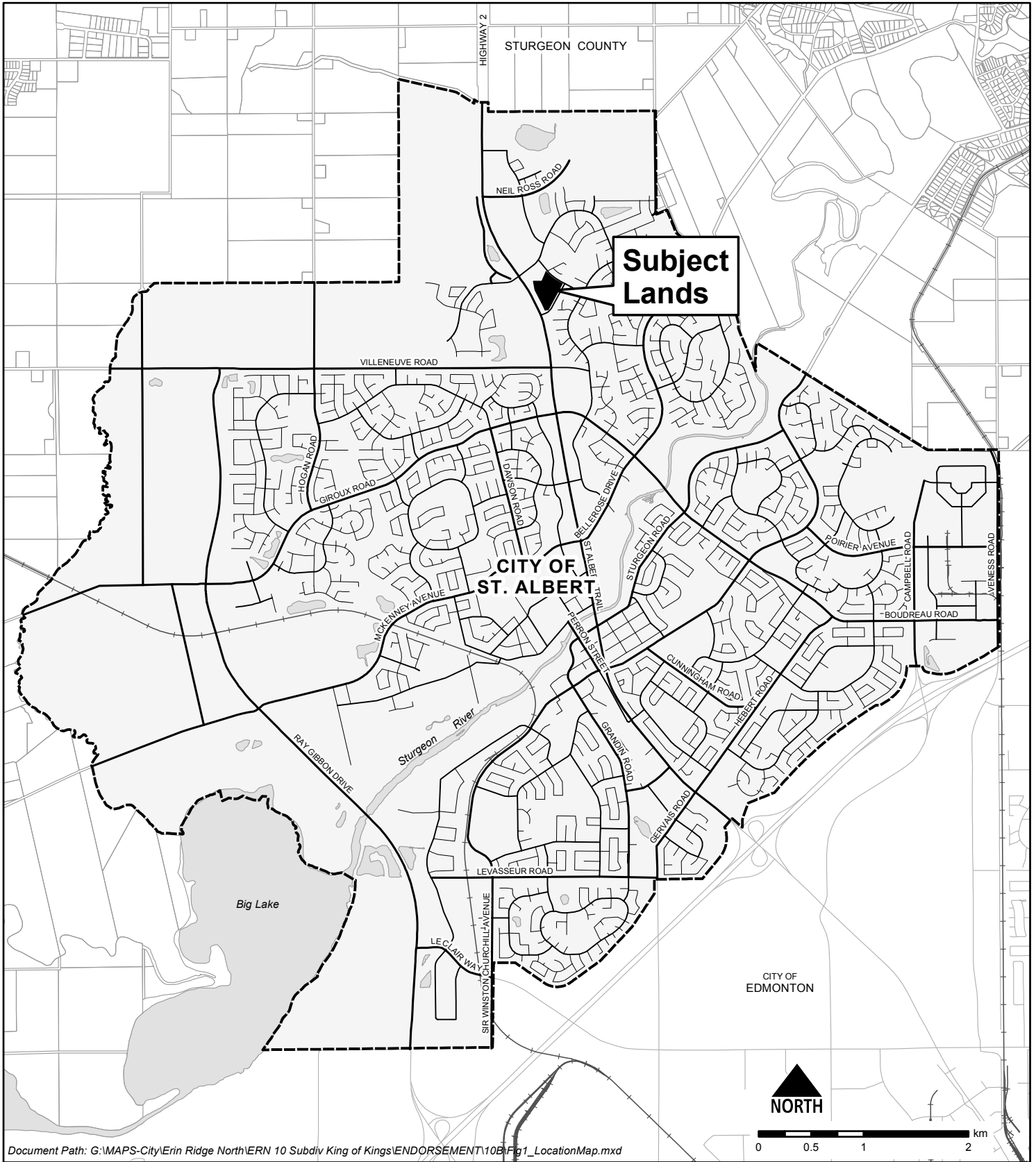

City of
St. Albert
Cultivate Life

Location Map
Erin Ridge North Stage 10B
2, 54211 Range Road 253

Figure 1